

RECEIVED
CLERK'S OFFICE

BEFORE THE ILLINOIS POLLUTION CONTROL BOARD

AUG 11 2005

STATE OF ILLINOIS
Pollution Control Board

GOLD STAR FS, INC. (LYNDON FACILITY))
(Property Identification Number)
15-15-302-006)
Petitioner,) **PCB** *06 18*
) **(Tax Certification)**
ILLINOIS ENVIRONMENTAL)
PROTECTION AGENCY)
Respondent.)

NOTICE

Dorothy M. Gunn, Clerk
Illinois Pollution Control Board
James R. Thompson Center
100 West Randolph Street, Suite. 11-500
Chicago, Illinois 60601

Marve Kading
Gold Star FS, Inc.
101 N. East Street
Cambridge, Illinois 61238

Steve Santarelli
Illinois Department of Revenue
101 West Jefferson
Post Office Box 19033
Springfield, Illinois 62794

PLEASE TAKE NOTICE that I have today filed with the Office of the Clerk of the Pollution Control Board an **APPEARANCE AND THE RECOMMENDATION** of the Illinois Environmental Protection Agency, a copy of which is herewith served upon you.

ENVIRONMENTAL PROTECTION AGENCY
OF THE STATE OF ILLINOIS

By: 

James Allen Day
Assistant Counsel
Division of Legal Counsel

DATED: August 8, 2005
Illinois Environmental Protection Agency
1021 North Grand Avenue East
Post Office Box 19276
Springfield, Illinois 62794-9276
217-782-5544

RECEIVED
CLERK'S OFFICE

AUG 11 2005

BEFORE THE ILLINOIS POLLUTION CONTROL BOARD

STATE OF ILLINOIS
Pollution Control Board

GOLD STAR FS, INC. (LYNDON FACILITY))
(Property Identification Number)
15-15-302-006))
Petitioner,) PCB *de 18*
) (Tax Certification)
ILLINOIS ENVIRONMENTAL)
PROTECTION AGENCY)
Respondent.)

A P P E A R A N C E

The undersigned, as one of its attorneys, hereby enters an APPEARANCE on behalf of the Respondent, Illinois Environmental Protection Agency.

ENVIRONMENTAL PROTECTION
AGENCY OF THE STATE OF ILLINOIS

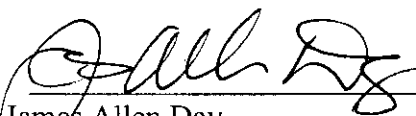
By: 
James Allen Day
Assistant Counsel
Division of Legal Counsel

DATED: August 8, 2005

Illinois Environmental Protection Agency
1021 North Grand Avenue East
Post Office Box 19276
Springfield, Illinois 62794-9276
217-782-5544

AUG 11 2005

BEFORE THE ILLINOIS POLLUTION CONTROL BOARD

STATE OF ILLINOIS
Pollution Control Board

GOLD STAR FS, INC. (LYNDON FACILITY))
(Property Identification Number)
15-15-302-006))
Petitioner,) **PCB** *06-18*
) **(Tax Certification)**
ILLINOIS ENVIRONMENTAL)
PROTECTION AGENCY)
Respondent.)

RECOMMENDATION

Now Comes the Illinois Environmental Protection Agency ("Illinois EPA") by James Allen Day, one of its attorneys, and pursuant to Section 125.204 of the Illinois Pollution Control Board's (Board) regulations files the following Recommendation regarding the tax certification of water pollution control facilities pursuant to 35 Ill. Adm. Code 125.204.

- 1) On December 6, 2004, the Illinois EPA received a request from Gold Star FS, Inc. for an Illinois EPA recommendation regarding the tax certification of water pollution control facilities at its Lyndon facility pursuant to 35 Ill. Adm. Code 125.204, and noted the request as log number TC-32-04. (Exhibit A)
- 2) The person authorized to receive the requested certification is:

Marve Kading
Gold Star FS, Inc.
101 N. East Street
Cambridge, Illinois 61238
- 3) The facility's location is:

Gold Star FS, Inc.
9506 Lyndon Road
P.O. Box 188
Lyndon, Illinois 61261
- 4) The water pollution control facilities in this request are located at Section 15, Township

20 North, Range 5 East of the 4th Principal Meridian in Whiteside County, Illinois at the above street address and include the following two separate facilities for purposes of this recommendation:

(a) Agrichemical containment structures consisting of two (2) liquid agrichemical operational area containment structures; two (2) bulk liquid agrichemical secondary containment structures; five (5) dry fertilizer operational containment structures; one (1) dry fertilizer blending operational containment structure; and the portion of the building over two (2) liquid agrichemical operational area containment structures, and one (1) dry fertilizer blending operational containment structure (26 ft. x 37 ft) as approved under the Agency endorsed Agrichemical Facility Permit No.92061479 (Log No. 04017745 issued April 24, 2004). (These facilities are further described in Exhibit A.)

(b) The portion of the building over the area for endloader transfer of bulk dry fertilizer between storage and the blenders measuring 27 feet by 99.5 feet. (These facilities are further described in Exhibit A.)

4. Section 11-10 of the Property Tax Code, 35 ILCS 200/11-10 (2000), defines “pollution control facilities” as: “any system, method, construction, device or appliance appurtenant thereto or any portion of any building or equipment, that is designed, constructed, installed or operated for the primary purpose of: (a) eliminating, preventing, or reducing air or water pollution ...or (b) treating, pretreating, modifying or disposing of any potential solid, liquid or gaseous pollutant which if released without treatment,

pretreatment modification or disposal might be harmful, detrimental or offensive to human, plant or animal life, or to property.”

5. Pollution control facilities are entitled to preferential tax treatment, 35 ILCS 200/11-5 (2000).
6. With respect to the facilities described in Paragraph 3(a) above (the containment structures), based on the information in the application and the purpose of the facilities (to collect, transport, and store agrichemical rinsates, residues, or washwaters prior to reuse or disposal), it is the Illinois EPA’s engineering judgment that the described facilities may be considered “pollution control facilities,” pursuant to 35 Ill. Adm. Code 125.200(a), with the primary purpose of eliminating, preventing, or reducing water pollution, or as otherwise provided in 35 Ill. Adm. Code 125.200. Therefore, the facilities are eligible for tax certification from the Board.
7. With respect to the facilities described in Paragraph 3(b) above (the portion of the building over the area for endloader transfer and blenders), based on the information in the application and the purpose of the facilities (to protect products from moisture), it is the Illinois EPA’s engineering judgment that the described facilities are not “pollution control facilities,” pursuant to 35 Ill. Adm. Code 125.200(a), with the primary purpose of eliminating, preventing, or reducing water pollution, or as otherwise provided in 35 Ill. Adm. Code 125.200. Therefore, the facilities are not eligible for tax certification from the Board.
8. Therefore, the Illinois EPA recommends that the Board issue the requested tax certification for the facilities described in Paragraph 3(a) above (the containment structures) and deny the requested tax certification for the facilities described in

Paragraph 3(b) above (the portion of the building over the area for endloader transfer and blenders).

Illinois Environmental Protection Agency

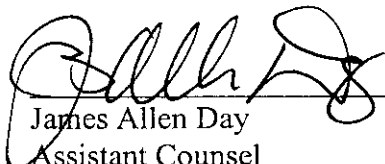
By: 
James Allen Day
Assistant Counsel
Division of Legal Counsel

August 8, 2005

Illinois Environmental Protection Agency
1021 North Grand Ave. E.
P.O. Box 19276
Springfield, Illinois 62794-9276
217/782-5544

STATE OF ILLINOIS

COUNTY OF SANGAMON

)
)
)
)
)

PROOF OF SERVICE

I, the undersigned, on oath state that I have served the attached **APPEARANCE AND RECOMMENDATION**, upon the person to whom it is directed, by placing a copy in an envelope addressed to:

Dorothy M. Gunn, Clerk
Illinois Pollution Control Board
James R. Thompson Center
100 West Randolph Street, Suite. 11-500
Chicago, Illinois 60601

Marve Kading
Gold Star FS, Inc.
101 N. East Street
Cambridge, Illinois 61238

Steve Santarelli
Illinois Department of Revenue
101 West Jefferson
Post Office Box 19033
Springfield, Illinois 62794

and mailing it from Springfield, Illinois on **August 8, 2005** with sufficient postage affixed for first class mail.

Nancy Lampert

SUBSCRIBED AND SWORN TO BEFORE ME
this eighth day of August, 2005

Brenda Boehner
Notary Public

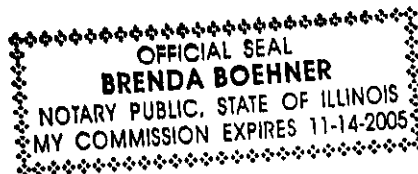

Watershed Land Tax Certification Review Sheet

Project Name: Cold Star FS, Inc.
Reviewer: JRA
Log No: TC-32-04

Location: Lyndon
Date: 12 Jan 05
Type: *Agacnem
= Livestock

Marva Kadina
101 N. East Street
Cambridge IL 61238
(309) 437-3369

Contact: Kelly Honegger
Phone: (618) 656-8086

Facility:

SS06 Lyndon Road
PO Box 188
Lyndon IL 61261

Property ID: 15-15-302-006

1421 Description: Spc 15 T20 N RSF of 42 y⁴W

County: White side

Date Control: _____
Devices installed: 1987 _____

Provided
Fair Cash
Value: \$ 100,000

Signature: Morve Kading

Title: Service Dept Manager

Wastes: ☐ Livestock waste is applied to cropland.
☒ Agrichemical rinsate and spillage is recycled through the facility and/or land applied.
☐ Other: _____

Physical Description of Pollution Control Devices:

[illegible]

Other:

AgChem

Project Name: Gold Star - Lyndon

Log No.: TC- 32-04

Permit Number: 92061479

04017745 issued April 24, 2004

Number

Description

Log Number

Liquid agrichemical operational area containment structures

OC-1	6' x 4' x 6' x 8' cone - load, wash
OC-2	12' x 12' x 0.5' cone - unloading

0401 7745

Dry fertilizer blended with pesticide operational containment structures

Bulk liquid agricultural secondary containment structures SC-1 20' x 40' x 2' conc - pest

04017745

Minibulk/package agrichemical secondary containment structures

The portion of the building over

Liquid agricchemical operational area
containment structures

64017745

Dry fertilizer blended with pesticide operational containment structures

Bulk liquid agrichemical secondary containment structures

Dry fertilizer blending operational containment structures 25' x 33'

0417785

Associated collection and recovery systems - 27 x 9560

Dry fertilizer operational containment structures

04017745

27' x 49.5' conc - end frame b/w storage & blender
15' x 15.17' conc - unloading
19' x 65.6' conc - conveyor
15' x 15' conc - unloading
Dry fertilizer blending operational containment structures
26' x 37' conc
04017745

Dry fertilizer aisleway operational containment structure

600
 420
 1. 148
 600
 630
 300
 200
 115
 120
 1 100
 2. 798

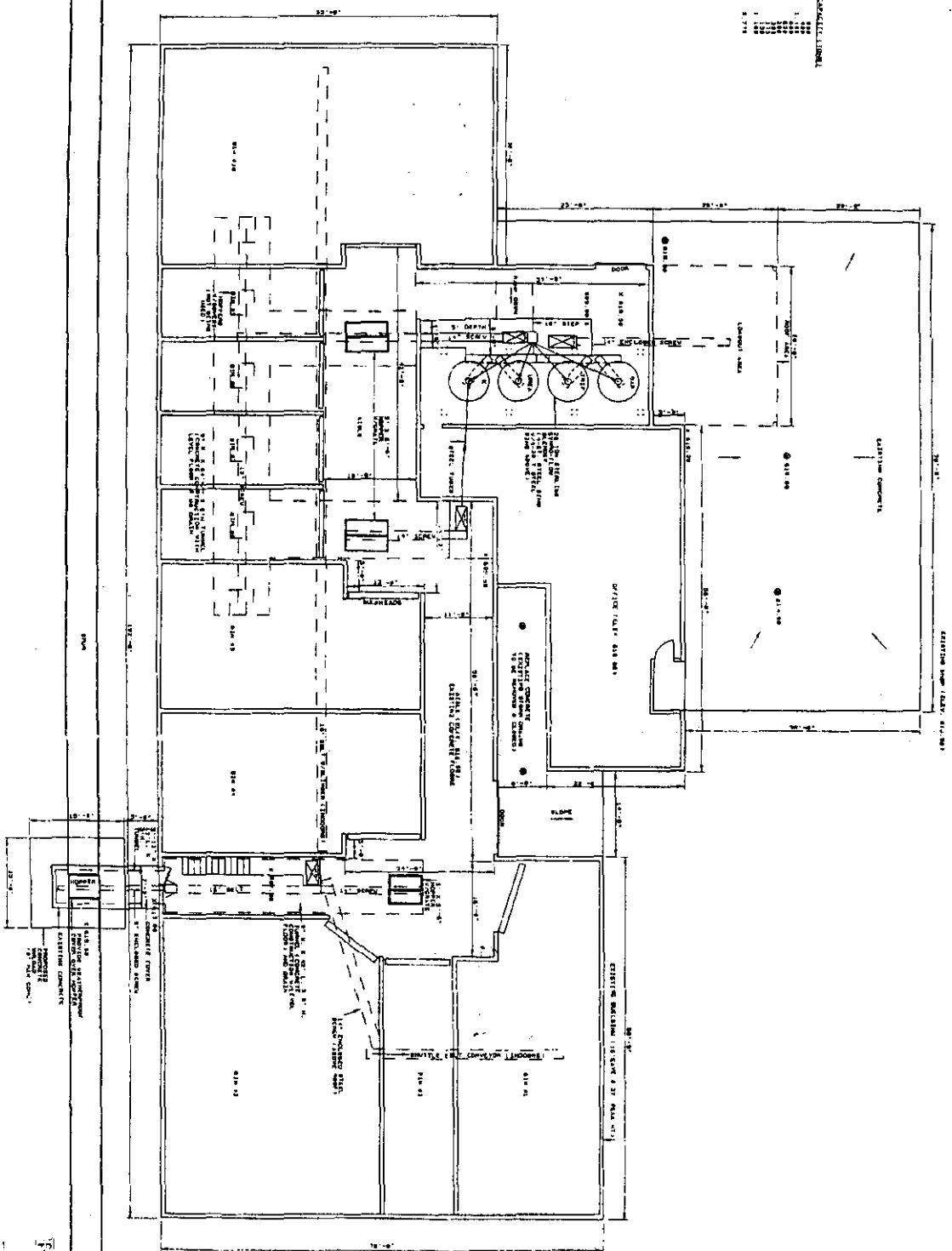

REACTIVE

[illegible]

1970

DRY FERTILIZER FLOW DIAGRAM

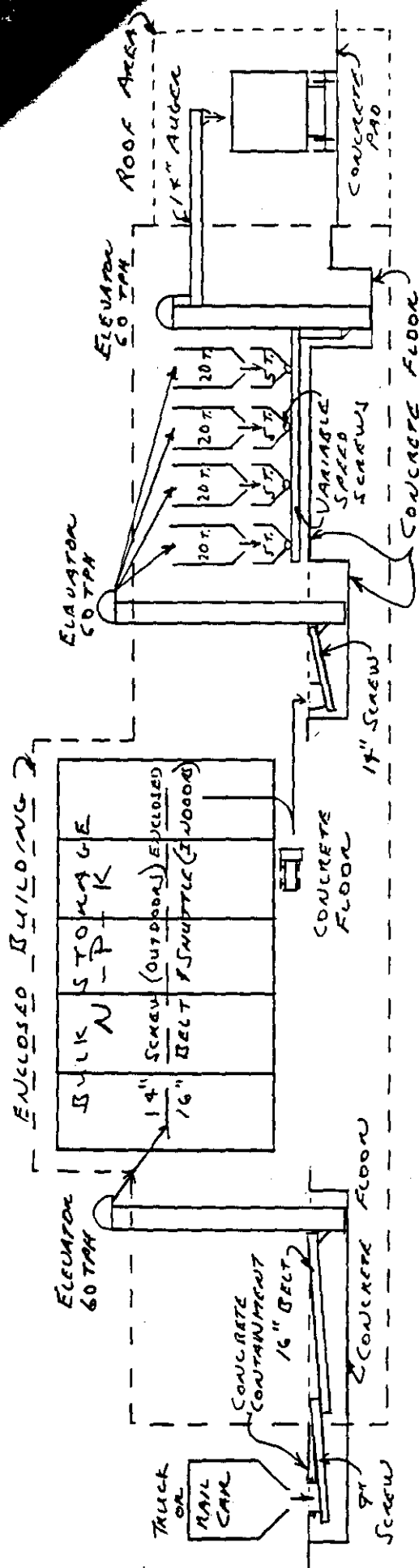

1. STORAGE: ENCLOSED WOOD FRAME BUILDING, CONCRETE FLOOR, 10 BINS.
2. BLENDER: ENCLOSED, CONCRETE FLOOR, 20 T. STIRLING.
3. END LOADER: ENCLOSED, CONCRETE FLOOR. SPILLAGE CLEANED UP DAILY & REUSED.
4. LOADOUT: UNDER ROOF, CONCRETE FLOOR. SPILLAGE CLEANED UP DAILY & REUSED.
5. TRUCK & RAIL CAR UNLOAD: OUTDOORS, CONCRETE PAD. SWEEP & CLEAN UP AFTER EACH OPERATION.
6. PARTICULATE EMISSION: SHROUDED OR DROP SPOUTS TO CONTROL DUST.

RECEIVED

APR 25 1995

Environmental Protection Agency
Division of Water Pollution Control
Permit Section-Springfield
State of Illinois

SCHEDULE D ATT. 1

FLOW DIAGRAM FOR
DRY FERTILIZER

WHITESIDE FS, INC.
LYNDON, IL.
3-17-95

Floyd McKinney
WPC - Rockford
APC - Peoria

State of Illinois
Department of Agriculture
AGRICHEMICAL CONTAINMENT PERMIT

DLH
Records
Binds

Permittee:	Facility ID Number:	1953100000
Gold Star FS, Inc.	Facility Name:	Lyndon, IL
9506 Lyndon Road		
Lyndon, IL 61261		
Permit #:	AI92061479	745
Facility Type:	Commercial	202004
Date Issued:	April 24, 2004	April 24, 2009

Permit is hereby granted to the above designated permittee to construct and operate an agrichemical containment facility as follows:

OPERATIONAL CONTAINMENT STRUCTURES

Operation of an existing reinforced concrete operational containment structure with the greatest dimensions measuring 48' (width) x 64' (length) x 1' (depth) with a total design capacity of 1077.0 cubic feet (ft.³). The floor shall slope to a series of six (6) sumps (three (3) sumps for the separation of solids and three (3) sumps for the recovery of liquids), each sump measuring 1.5' (width) x 1.5' (length) x 2' (depth) to facilitate the collection and recovery of all escaped product and/or agrichemical wastewater. All recovered effluent shall be transferred to one (1) of two (2) 200 gallon recovery tanks with a manually activated sump pump. Segregation shall be performed based upon the applicable target crop and label use. All loading, washing and limited unloading of bulk liquid agrichemical transportation and application equipment shall be performed upon the herein permitted structure. This structure shall be referred to as OC-1.

Operation of an existing reinforced concrete operational containment structure measuring 12' (width) x 12' (length) x 0.5' (depth) with a total design capacity of 65.2 cubic feet (ft.³). The floor shall slope to a single sump measuring 1.5' (width) x 1.5' (length) x 0.75' (depth) to facilitate the collection and recovery of all escaped product and/or agrichemical wastewater. All recovered effluent shall be transferred to one (1) of the two (2) aforementioned 200 gallon recovery tanks with a manually activated sump pump. Segregation shall be performed based upon the applicable target crop and label use. The unloading of bulk liquid agrichemical transportation and application equipment shall be performed upon the herein permitted structure. This structure shall be referred to as OC-2.

RECEIVED

MAY 11 2004

Watershed Management Section
BUREAU OF WATER



State of Illinois
Department of Agriculture
AGRICHEMICAL CONTAINMENT PERMIT

SECONDARY CONTAINMENT STRUCTURES

Operation of an existing reinforced concrete secondary containment structure measuring 20' (width) x 40' (length) x 2' (height) with a total design capacity of 1405.6 cubic feet (ft^3). The floor shall slope to a single sump measuring 1.5' (width) x 1.5' (length) x 0.75' (depth) to facilitate the collection and recovery of all escaped product and/or agrichemical wastewater. All recovered effluent shall be transferred to one (1) of the two (2) aforementioned 200 gallon recovery tanks with a manually activated sump pump. Segregation shall be performed based upon the applicable target crop and label use. All bulk liquid pesticides shall be stored within the said structure. This structure shall be referred to as SC-1.

Operation of an existing reinforced concrete secondary containment structure measuring 34' (width) x 60' (length) x 4' (height) with a total design capacity of 7281.4 cubic feet (ft^3). The floor shall slope to a single sump measuring 1.5' (width) x 1.5' (length) x 0.75' (depth) to facilitate the collection and recovery of all escaped product and/or agrichemical wastewater. All recovered effluent shall be transferred to one (1) of the two (2) aforementioned 200 gallon recovery tanks with a manually activated sump pump. Segregation shall be performed based upon the applicable target crop and label use. All bulk liquid fertilizer shall be stored within the said structure. This structure shall be referred to as SC-2.

BULK DRY FERTILIZER STRUCTURES

Operation of an existing bulk dry fertilizer storage building measuring 85' (width) x 192' (length) with an estimated total storage capacity of 5775 tons. The structure is composed of ten (10) storage bins (one (1) bin measuring 23' (width) x 58.5' (length) with an estimated storage capacity of 900 tons each, one (1) storage bin measuring 11' (width) x 43' (length) with an estimated total storage capacity of 400 tons, one (1) bin measuring 35' (width) x 49' (length) with an estimated storage capacity of 1400 tons, one (1) bin measuring 23' (width) x 41.5' (length) with an estimated storage capacity of 600 tons, one (1) bin measuring 23.5' (width) x 41.5' (length) with an estimated storage capacity of 650 tons, two (2) bins, each bin measuring 11' (width) x 26' (length) with an estimated storage capacity of 200 tons each, one (1) bin measuring 11' (width) x 26' (length) with an estimated storage capacity of 175 tons, one (1) bin measuring 11' (width) x 26' (length) with an estimated storage capacity of 150 tons, and one (1) bin measuring 35' (width) x 53.5' (length) with an estimated storage capacity of 1100 tons).

All bulk dry fertilizer shall be stored within the herein permitted structures.

Operation of an existing reinforced concrete operational containment structure measuring 27' (width) x 99.5' (length). All endloader transfer of bulk dry fertilizer between storage and the blender shall be performed upon the herein permitted structure.



State of Illinois
Department of Agriculture
AGRICHEMICAL CONTAINMENT PERMIT

Operation of an existing reinforced concrete operational containment structure measuring 15' (width) x 15.17' (length). The unloading of bulk dry fertilizer transportation and application equipment shall be performed upon the herein permitted structure.

Operation of an existing reinforced concrete operational containment structure measuring 26' (width) x 37' (length). All blending of bulk dry fertilizer shall be performed upon the herein permitted structure.

Operation of an existing reinforced concrete operational containment structure measuring 19' (width) x 65.6' (length). The conveyor transfer of bulk dry fertilizer from the unloading structure to the bulk dry fertilizer storage building shall be performed upon the herein permitted structure.

Operation of an existing reinforced concrete operational containment structure with the greatest dimensions measuring 43' (width) x 79' (length). All loading of bulk dry fertilizer transportation and application equipment shall be performed upon the herein permitted structure.

Operation of an existing reinforced concrete and steel operational containment structure measuring 15' (width) x 15' (length). The unloading of bulk dry fertilizer transportation and application equipment shall be performed upon the herein permitted structure.

There shall be no discharge of wastewater from the herein permitted facilities.

This permit has been reviewed and approved by the Illinois Environmental Protection Agency per the attached permit endorsement. This permit is subject to standard conditions on the reverse side of this document and the following special conditions:

SPECIAL CONDITION 1: The permittee shall provide backflow protection in accordance with the Illinois Department of Public Health Plumbing Code (77 Ill. Adm. Code 890) and the Illinois Environmental Protection Agency's Technical Policy Statement (55 Ill. Adm. Code 653.803(c)(4)).

SPECIAL CONDITION 2: The permittee may discharge accumulated precipitation from the herein permitted bulk liquid fertilizer secondary containment structure (SC-2) pursuant to 8 Illinois Administrative Code 255.110 (a) (2) (A) and (B).

SPECIAL CONDITION 3: The permittee shall operate the exposed dry fertilizer operations pursuant to 8 Illinois Administrative Code 255.140 (a), (c) and (d).

SPECIAL CONDITION 4: The permittee shall employ concentric piping for the piping span from the bulk liquid fertilizer secondary containment structure (SC-2) to the operational containment structure (OC-1).



State of Illinois
Department of Agriculture
AGRICHEMICAL CONTAINMENT PERMIT

SPECIAL CONDITION 5: The permittee shall cover the drains located in the dry fertilizer loading structure during operations to prevent any dry fertilizer from entering these drains.

THE STANDARD CONDITIONS OF ISSUANCE ON THE REVERSE SIDES OF THIS MUST BE COMPLIED WITH IN FULL.

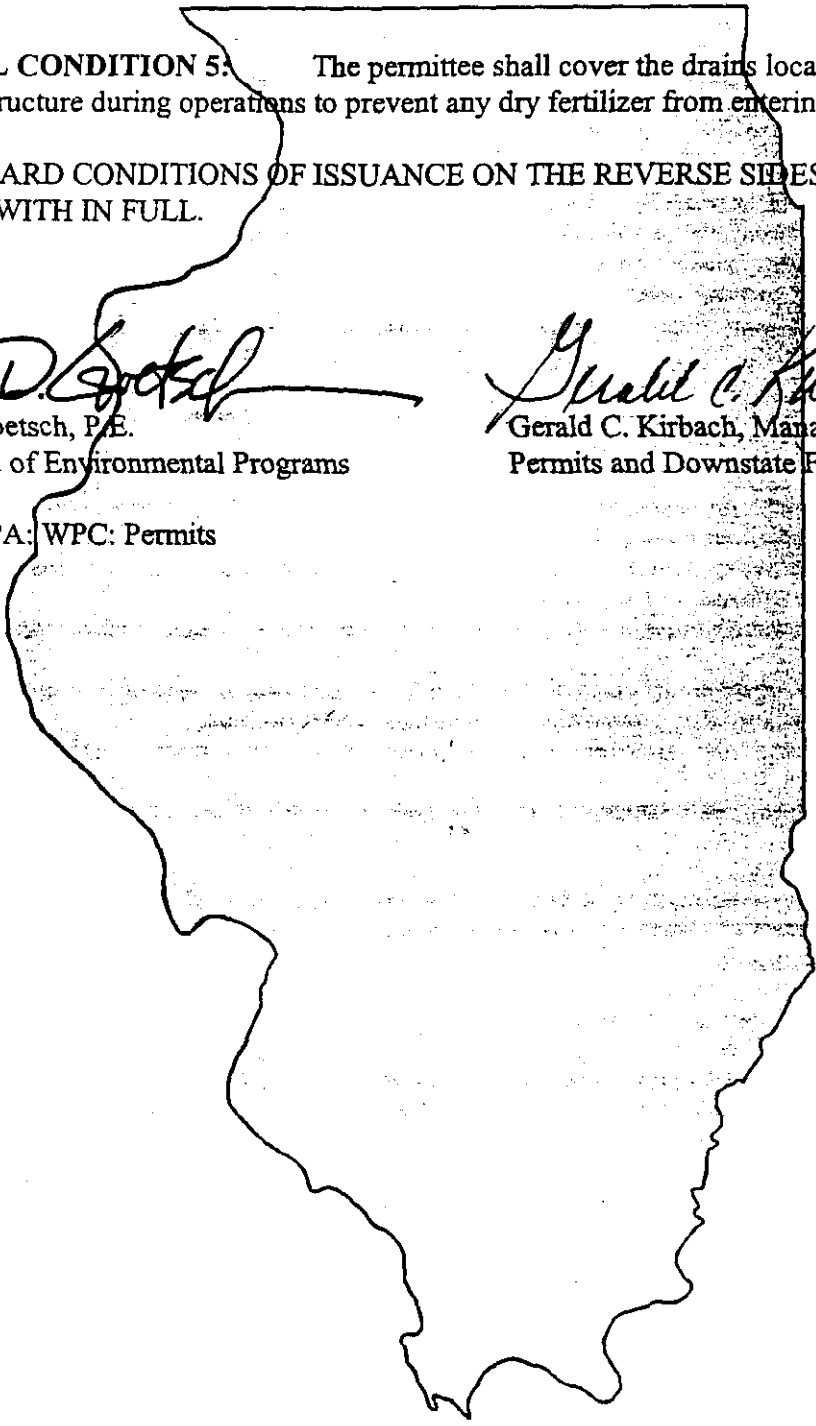

Warren D. Goetsch

Warren D. Goetsch, P.E.
Chief, Bureau of Environmental Programs

Gerald C. Kirbach

Gerald C. Kirbach, Manager
Permits and Downstate Field Operations

cc: Illinois EPA; WPC: Permits
file
a:195310.per



APPLICATION FOR CERTIFICATION (PROPERTY TAX TREATMENT)
POLLUTION CONTROL FACILITY
 AIR ☐ WATER ☒

ILLINOIS ENVIRONMENTAL PROTECTION AGENCY
 P. O. Box 19276, Springfield, IL 62794-9276

This Agency is authorized to request this information under Illinois Revised Statutes, 1979, Chapter, 120, Section 502a-5. Disclosure of this information is voluntary. However, failure to comply could prevent your application from being processed or could result in denial of your application for certification.

FOR AGENCY USE

File No. _____ Date Received _____ Certification No. _____ Date **11/24/04**

APPLICANT	Sec. A		Company Name Gold Star FS Inc.		
			Person Authorized to Receive Certification Marve Kading		Person to Contact for Additional Details Keith Honegger
			Street Address 101 N. East Street		Street Address 3200 Old Troy Road
			Municipality, State & Zip Code Cambridge, IL 61238		Municipality, State & Zip Code Glen Carbon, IL 62034
			Telephone Number 309/937-3369		Telephone Number 618/656-8046
			Location of Facility Quarter Section _____ Township _____ Range _____		Municipality _____ Township _____
			SEC 15 TWP 20N R5		Lyndon Lyndon
			Street Address 9506 Lyndon Road P.O. 188		County _____ Book Number _____
			Whiteside		
		Property Identification Number 15-15-302-006		Parcel Number _____	
MANUFACTURING OPERATIONS	Sec. B		Nature of Operations Conducted at the Above Location Mixing, Loading, and Storing of Agrichemicals and Fertilizers		
			Water Pollution Control Construction Permit No. 92061479		Date Issued April 24, 2004
			Log# 04017745		
			NPDES PERMIT No. _____		Date Issued _____ Expiration Date _____
			Air Pollution Control Construction Permit No. _____		Date Issued _____
MANUFACTURING PROCESS	Sec. C		Describe Unit Process <div style="text-align: center; font-size: 2em; font-weight: bold;">RECEIVED</div> <div style="text-align: center;">DEC 06 2004</div>		
			Materials Used in Process <div style="text-align: center;">ILLINOIS ENVIRONMENTAL PROTECTION AGENCY BOW/WPC/PERMIT SECTION</div>		
POLLUTION CONTROL FACILITY DESCRIPTION	Sec. D		Describe Pollution Abatement Control Facility 1) Agrichemical containment structure consisting of two agrichemical operational area containment structures (48' x 64' x 1' & 12' x 12' x .5') and two secondary containment structures (20' x 40' x 2' & 34' x 60' x 4') and the building covering the two operational containment structures. Six bulk fertilizer operational containment structures (27' x 99.5', 15' x 15.7', 26' x 37', 19' x 65.6', 43' x 79' & 15' x 15') and the building over the 26' x 37' containment area used for the blending of bulk dry fertilizer and the portion of the building over the operational containment area used for the conveyance of bulk dry fertilizer from storage to blending (27' x 99.5'); associated collection and recover systems as endorsed by Agrichemical Facility Permit No. 92061479 Log # 04017745.		

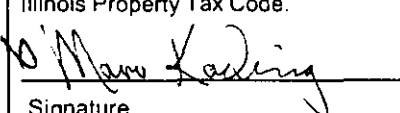
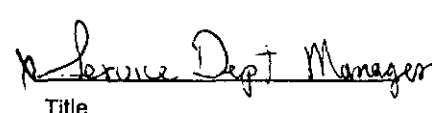
POLLUTION CONTROL FACILITY - CONTAMINANTS ACCOUNTING DATA	Sec. E (1) Nature of Contaminants or Pollutants			
			Material Retained, Captured or Recovered	
	Contaminant or Pollutant	DESCRIPTION	DISPOSAL OR USE	
	Fertilizer	Various Nitrogen, Phosphorus & Potash	Recycle	
	(2) Point(s) of Waste Water Discharge			
		Plans and Specifications Attached	Yes <input type="checkbox"/> No <input checked="" type="checkbox"/>	
(3)	Are contaminants (or residues) collected by the control facility?		Yes <input checked="" type="checkbox"/> No <input type="checkbox"/>	
(4)	Date installation completed 1987 status of installation on date of application operational			
(5)	a. FAIR CASH VALUE IF CONSIDERED REAL PROPERTY:		\$ 100,000	
	b. NET SALVAGE VALUE IF CONSIDERED REAL PROPERTY:		\$ 10,000	
	c. PRODUCTIVE GROSS ANNUAL INCOME OF CONTROL FACILITY:		\$ 0	
	d. PRODUCTIVE NET ANNUAL INCOME OF CONTROL FACILITY:		\$ 0	
	e. PERCENTAGE CONTROL FACILITY BEARS TO WHOLE FACILITY VALUE:		% 100	
SIGNATURE	Sec. F The following information is submitted in accordance with the Illinois Property Tax Code, as amended, and to the best of my knowledge, is true and correct. The facilities claimed herein are "pollution control facilities" as defined in Section 11-10 of the Illinois Property Tax Code.			
	 Signature		 Title	
INSTRUCTIONS	Sec. G INSTRUCTIONS FOR COMPILING AND FILING APPLICATION			
	General: Separate applications must be completed for each control facility claimed. Do not mix types (water and air). Where both air and water operations are related, file two applications. If attachments are needed, record them consecutively on an index sheet.			
	Sec. A	Information refers to applicant as listed in the tax records and the person to be contacted for further details or for inspection of facilities. Define facility location by street address or legal description. A plat map location is required for facilities located outside of municipal boundaries. The property identification number is required.		
	Sec. B	Self-explanatory. Submit copies of all permits issued by local pollution control agencies. (e.g. MSD Construction Permit)		
	Sec. C	Refers to manufacturing processes or materials on which pollution control facility is used.		
	Sec. D	Narrative description of the pollution control facility, indicating that its primary purpose is to eliminate, prevent or reduce pollution. State the type of control facility. State permit number, date, and agency issuing permit. A narrative description and a process flow diagram describing the pollution control facility. Include a listing of each major piece of equipment included in the claimed fair cash value for real property. Include an average analysis of the influent and effluent of the control facility stating the collection efficiency.		
	Sec. E	List air contaminants, or water pollution substances released as effluents to the manufacturing processes. List also the final disposal of any contaminants removed from the manufacturing processes. Item (1) - Refers to pollutants and contaminants removed from the process by the pollution control facility. Item (2) - Refers to water pollution but can apply to water-carried wastes from air pollution control facilities. Submit drawings, which clearly show (a) Point(s) of discharge to receiving stream, and (b) Sewers and process piping to and from the control facility. Item (3) - If the collected contaminants are disposed of other than as wastes, state the disposition of the materials, and the value in dollars reclaimed by sale or reuse of the collected substances. State the cost of reclamation and related expense. Item (4) - State the date which the pollution control facility was first placed in service and operated. If not, explain. Item (5) - This information is essential to the certification and assessment actions. This accounting data must be completed to activate project review prior to certification by this Agency.		
	Sec. F	Self-explanatory. Signature must be a corporate authorized signature.		
		Submit to:	Attention:	Attention:
		Illinois EPA P.O. Box 19276 Springfield, IL 62794-9276	Thomas McSwiggin Permit Section Division of Water Pollution Control	Donald E. Sutton Permit Section Division of Air Pollution Control

State of Illinois
Department of Agriculture
AGRICHEMICAL CONTAINMENT PERMIT

Permittee: Gold Star FS, Inc. 9506 Lyndon Road Lyndon, IL 61261	Facility ID Number: AC1953100000 Facility Location: Lyndon, IL
Permit #: AC92061479 Facility Type: Commercial Retail Dealer Date Issued: April 24, 2004	Log Number: 34014745 Date Received: January 20, 2004 Expiration Date: April 24, 2009

Permit is hereby granted to the above designated permittee to construct and operate an agrichemical containment facility as follows:

OPERATIONAL CONTAINMENT STRUCTURES

Operation of an existing reinforced concrete operational containment structure with the greatest dimensions measuring 48' (width) x 64' (length) x 1' (depth) with a total design capacity of 1077.0 cubic feet (ft.³). The floor shall slope to a series of six (6) sumps (three (3) sumps for the separation of solids and three (3) sumps for the recovery of liquids), each sump measuring 1.5' (width) x 1.5' (length) x 2' (depth) to facilitate the collection and recovery of all escaped product and/or agrichemical wastewater. All recovered effluent shall be transferred to one (1) of two (2) 200 gallon recovery tanks with a manually activated sump pump. Segregation shall be performed based upon the applicable target crop and label use. All loading, washing and limited unloading of bulk liquid agrichemical transportation and application equipment shall be performed upon the herein permitted structure. This structure shall be referred to as **OC-1**.

Operation of an existing reinforced concrete operational containment structure measuring 12' (width) x 12' (length) x 0.5' (depth) with a total design capacity of 65.2 cubic feet (ft.³). The floor shall slope to a single sump measuring 1.5' (width) x 1.5' (length) x 0.75' (depth) to facilitate the collection and recovery of all escaped product and/or agrichemical wastewater. All recovered effluent shall be transferred to one (1) of the two (2) aforementioned 200 gallon recovery tanks with a manually activated sump pump. Segregation shall be performed based upon the applicable target crop and label use. The unloading of bulk liquid agrichemical transportation and application equipment shall be performed upon the herein permitted structure. This structure shall be referred to as **OC-2**.



AGRICHEMICAL CONTAINMENT PERMIT

Gold Star FS, Inc.

Page: 2

SECONDARY CONTAINMENT STRUCTURES

Operation of an existing reinforced concrete secondary containment structure measuring 20' (width) x 40' (length) x 2' (height) with a total design capacity of 1405.6 cubic feet (ft^3). The floor shall slope to a single sump measuring 1.5' (width) x 1.5' (length) x 0.75' (depth) to facilitate the collection and recovery of all escaped product and/or agrichemical wastewater. All recovered effluent shall be transferred to one (1) of the two (2) aforementioned 200 gallon recovery tanks with a manually activated sump pump. Segregation shall be performed based upon the applicable target crop and label use. All bulk liquid pesticides shall be stored within the said structure. This structure shall be referred to as SC-1.

Operation of an existing reinforced concrete secondary containment structure measuring 34' (width) x 60' (length) x 4' (height) with a total design capacity of 7281.4 cubic feet (ft^3). The floor shall slope to a single sump measuring 1.5' (width) x 1.5' (length) x 0.75' (depth) to facilitate the collection and recovery of all escaped product and/or agrichemical wastewater. All recovered effluent shall be transferred to one (1) of the two (2) aforementioned 200 gallon recovery tanks with a manually activated sump pump. Segregation shall be performed based upon the applicable target crop and label use. All bulk liquid fertilizer shall be stored within the said structure. This structure shall be referred to as SC-2.

BULK DRY FERTILIZER STRUCTURES

Operation of an existing bulk dry fertilizer storage building measuring 85' (width) x 192' (length) with an estimated total storage capacity of 5775 tons. The structure is composed of ten (10) storage bins (one (1) bin measuring 23' (width) x 58.5' (length) with an estimated storage capacity of 900 tons each, one (1) storage bin measuring 11' (width) x 43' (length) with an estimated total storage capacity of 400 tons, one (1) bin measuring 35' (width) x 49' (length) with an estimated storage capacity of 1400 tons, one (1) bin measuring 23' (width) x 41.5' (length) with an estimated storage capacity of 600 tons, one (1) bin measuring 23.5' (width) x 41.5' (length) with an estimated storage capacity of 650 tons, two (2) bins, each bin measuring 11' (width) x 26' (length) with an estimated storage capacity of 200 tons each, one (1) bin measuring 11' (width) x 26' (length) with an estimated storage capacity of 175 tons, one (1) bin measuring 11' (width) x 26' (length) with an estimated storage capacity of 150 tons, and one (1) bin measuring 35' (width) x 53.5' (length) with an estimated storage capacity of 1100 tons).

All bulk dry fertilizer shall be stored within the herein permitted structures.

Operation of an existing reinforced concrete operational containment structure measuring 27' (width) x 99.5' (length). All endloader transfer of bulk dry fertilizer between storage and the blender shall be performed upon the herein permitted structure.



AGRICHEMICAL CONTAINMENT PERMIT

Gold Star FS, Inc.

Page: 3

Operation of an existing reinforced concrete operational containment structure measuring 15' (width) x 15.17' (length). The unloading of bulk dry fertilizer transportation and application equipment shall be performed upon the herein permitted structure.

Operation of an existing reinforced concrete operational containment structure measuring 26' (width) x 37' (length). All blending of bulk dry fertilizer shall be performed upon the herein permitted structure.

Operation of an existing reinforced concrete operational containment structure measuring 19' (width) x 65.6' (length). The conveyor transfer of bulk dry fertilizer from the unloading structure to the bulk dry fertilizer storage building shall be performed upon the herein permitted structure.

Operation of an existing reinforced concrete operational containment structure with the greatest dimensions measuring 43' (width) x 79' (length). All loading of bulk dry fertilizer transportation and application equipment shall be performed upon the herein permitted structure.

Operation of an existing reinforced concrete and steel operational containment structure measuring 15' (width) x 15' (length). The unloading of bulk dry fertilizer transportation and application equipment shall be performed upon the herein permitted structure.

There shall be no discharge of wastewater from the herein permitted facilities.

This permit has been reviewed and approved by the Illinois Environmental Protection Agency per the attached permit endorsement. This permit is subject to standard conditions on the reverse side of this document and the following special conditions:

SPECIAL CONDITION 1: The permittee shall provide backflow protection in accordance with the Illinois Department of Public Health Plumbing Code (77 Ill. Adm. Code 890) and the Illinois Environmental Protection Agency's Technical Policy Statement (35 Ill. Adm. Code 653.803(c)(4)).

SPECIAL CONDITION 2: The permittee may discharge accumulated precipitation from the herein permitted bulk liquid fertilizer secondary containment structure (SC-2) pursuant to 8 Illinois Administrative Code 255.110 (a) (2) (A) and (B).

SPECIAL CONDITION 3: The permittee shall operate the exposed dry fertilizer operations pursuant to 8 Illinois Administrative Code 255.140 (a), (c) and (d).

SPECIAL CONDITION 4: The permittee shall employ concentric piping for the piping span from the bulk liquid fertilizer secondary containment structure (SC-2) to the operational containment structure (OC-1).



State of Illinois
Department of Agriculture
AGRICHEMICAL CONTAINMENT PERMIT

Gold Star FS, Inc.

Page: 4

SPECIAL CONDITION 5: The permittee shall cover the drains located in the dry fertilizer loading structure during operations to prevent any dry fertilizer from entering these drains.

THE STANDARD CONDITIONS OF ISSUANCE ON THE REVERSE SIDES OF THIS MUST BE COMPLIED WITH IN FULL.

Warren D. Goetsch, P.E.
Chief, Bureau of Environmental Programs

Gerald C. Kirbach, Manager
Permits and Downstate Field Operations

cc: Illinois EPA: WPC: Permits
file
a:195310.per

